

The product using material and processing must conform to the "WI-PZ-001"HSF technical standard control requirements

RoHS

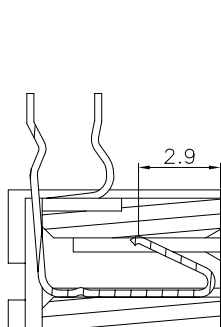

SECTION A-A

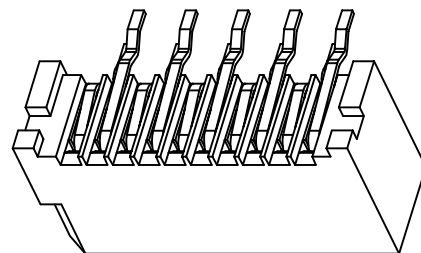
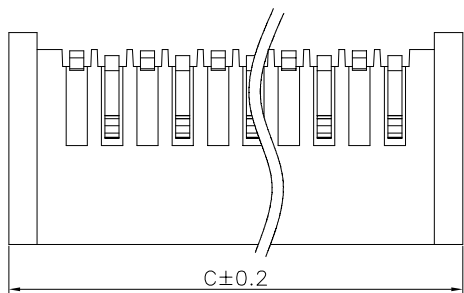
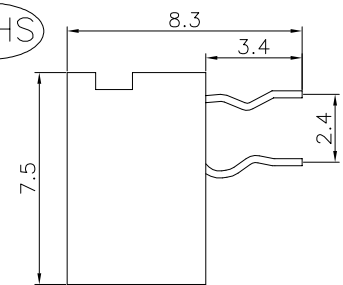
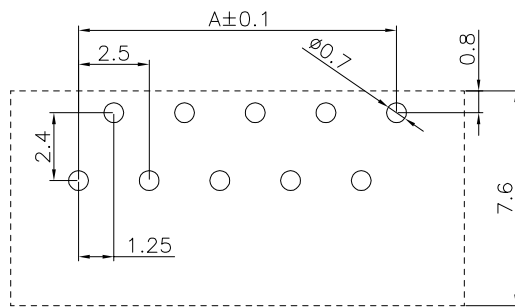
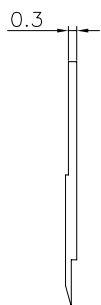
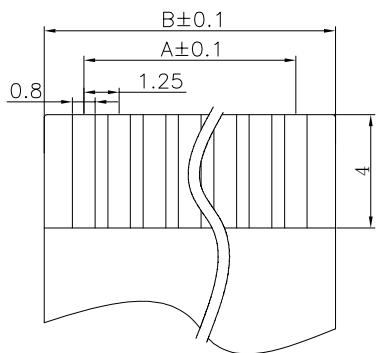
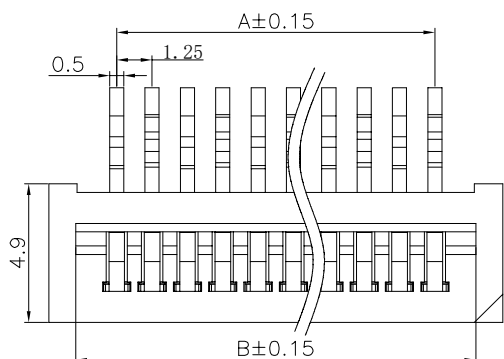

PCB Layout

ENOTE:

- 1.MATERIAL SPECIFICATION:
 - 1-1.HOUSING:LCP
 - 1-2.CONTACTS:PHOSPHOR COPPER
- 2.PLATING SPECIFICATION:
 - 2-1.CONTACTS: TIN/AU PLATED OVER ALL.
- 4.ELECTRICAL PERFORMANCE:
 - 4-1. RATED CURRENT : 1A AC,DC
 - RATED VOLTAGE : 50V AC/DC
 - 4-2.INSULATION RESISTANCE: 800MΩ MIN
 - CONTACT RESISTANCE : 30mΩ(MAX.)
 - 4-3.WITHSTANDING VOLTAGE: 500V AC/minute
- 5.ENVIRONMENTAL PERFORMANCE:
 - OPERATING TEMPERATURE: -25°C~+85°C.
- 6.PACKAGE SPEC: TUBE
- 7.P/N:

SERIES NO: F1251 49 F 9-1 XX 1 X X 01

HEIGHT: 49: 4.9mm

MALE FEMALE: F-FEMALE

ANGLE: 9-90°

ROW NO: 1-SINGLE ROW

COLOR: M-BEIGE, K-WHITE, S-NATURE

PLATING: A-ALL AU G/F, C-BRIGHE TIN, 1-G/F

TERMIPOINT: 1-DIP

PIN Q'PY: 02~16

Ordering Information & Dimensions

Circuit	Dimensions(mm)			Circuit	Dimensions(mm)		
	A	B	C		A	B	C
02	1.25	4.15	6.05	10	11.25	14.15	16.05
03	2.50	5.40	7.30	11	12.50	15.40	17.30
04	3.75	6.65	8.55	12	13.75	16.65	18.55
05	5.00	7.90	9.80	13	15.00	17.90	19.80
06	6.25	9.15	11.05	14	16.25	19.15	21.05
07	7.50	10.40	12.30	15	17.50	20.40	22.30
08	8.75	11.65	13.55	16	18.75	21.65	23.55
09	10.00	12.90	14.80				

REV.	REVISION RECORD	DATE	UNIT:mm	GENERAL TOLERANCES		SCALE:	NAME	DATE	PART.NO:	DWG.NO:	TITLE:	REV: A0	SHEET: 1/1
A0	NEW RELEASE	21.01.13		LINEAR	ANGLES	1:1							
				0.00±0.25	X'±3'	APPROVED	Wang_jr	21.01.13	F125149F9-1XX1XX01	ENDE05			
				0.00±0.10	X'X' ±2'	DESIGNER	Han_Gao	21.01.13			Pitch 1.25mm 90 ° A DIP		
			SIZE: A4			DRAWN	Zijun_Huang	21.01.13					



WanLian Teconology Co., Ltd